

# X-stainless steel ball valves, full bore

250X series, X-series, welding / welding, EN (DIN), DN 15-40, full bore

Body	DN 15-40 Stainless steel, AISI316L (1.4404)
Ball	DN 15-40 Stainless steel, AISI316L (1.4404)
Ball seal	DN 15-40 PTFE+C
Stem	DN 15-40 Stainless steel, AISI316L (1.4404)
Stem seal	DN 15-40 FPM/NBR
Operation	DN 15-40 with composite handle



## Operation conditions

-20 ° – +200 °C  
 Below -20 °C contact manufacturer  
 Lowest allowed ambient temperature -40 °C  
 Leakage rate A (EN 12266-1)

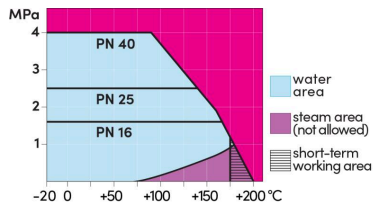

DN 15-40

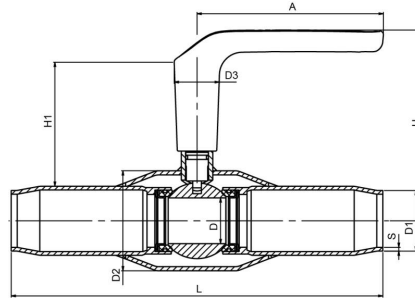

DN	PN	Product no.	A	D	D1	D2	D3	H	H1	L	S	kg
15	40	250015X	130	15	21.3	42.4	32.0	123	87	230	2	0.9
20	40	250020X	130	20	26.9	48.3	32.0	125	86	230	2	1.2
25	40	250025X	130	25	33.7	60.3	32.0	129	85	260	2	1.7
32	40	250032X	130	32	42.4	70.0	32.0	133	87	260	2.6	2.3
40	40	250040X	130	40	48.3	76.1	32.0	140	88	300	2.8	3.4