

Universal Flange Series 2200-L "Liberty"

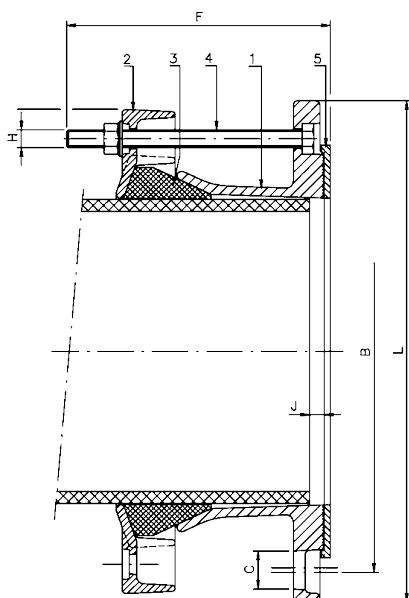

Technical specifications

- Nodular cast iron, GGG-50 quality.
- EPOXY coating (150 microns).
- Enables pipes made of different materials and with different outside diameters to be joined.
- Can be used as a dismantling joint.
- Suitable for ISO, DIN (PN-10/16), BS, ANSI 150 lb, BSTD.
- The lighter weight and easier handling of this range gives workers greater freedom of movement.
- Maximum working pressure 16 bar.
- Angular deflection +/-6°.



REF.	DN	D1 (Min)	D1 (Max)	L	B	C	F	J (Min)	J (Max)	H	Weight kg
2200-A / L	40 / 50	47	60	165	100/125	19	140	10	45	M12 x 130	4
2200 / L	50 / 65	57	72	194	114/147	19	140	10	55	M12 x 130	5
2201 / L	50 / 65	68	85	207	125/160	19	140	15	55	M12 x 130	6
2202 / L	65 / 80 / 100	84	106	224	146/190	19	140	10	55	M12 x 130	5,8
2203 / L	100 / 125	103	116	250	178/216	19	140	10	55	M12 x 130	7,8
2204 / L	100 / 125	108	130	250	178/216	19	150	10	55	M12 x 140	7
2205 / L	125 / 150	128	146	286	210/242	22	140	10	55	M12 x 130	9,6
2206 / L	125 / 150	134	155	286	210/242	22	150	10	55	M12 x 140	9,1
2207 / L	150 / 175 / 200	153	175	340	237/298	23	140	10	55	M12 x 130	10,7
2208 / L	150 / 175 / 200	165	185	340	237/298	23	150	10	55	M12 x 140	11,2
2209 / L	175 / 200	184	207	342	290/301	23	170	10	70	M12 x 160	13,6
2210 / L	200	208	225	348	295/301	23	170	10	70	M12 x 160	14,5
2210-A / L	200	218	236	348	295	23	170	15	70	M12 x 160	13,6
2211 / L	200	222	250	370	295	23	170	28	70	M12 x 160	14,6
2211-A / L	250	246	270	406	350/364	27	170	10	80	M12 x 160	18,4
2212 / L	250	264	284	406	350/364	27	170	10	70	M12 x 160	18,4
2212-A / L	250	282	306	435	355	26	190	28	80	M12 x 180	21,9
2213 / L	300	305	326	482	400/434	27	170	10	70	M12 x 160	23
2213-A / L	300	315	335	482	400/434	27	170	10	80	M12 x 160	27,4
2213-B / L	300	334	355	485	405/440	27	170	78	80	M12 x 160	28
2213-C / L	300	360	386	498	404/440	27	260	83	155	M12 x 250	36,4
2214 / L	350	360	386	533	460/479	27	170	10	70	M12 x 160	25
2214-A / L	350	386	410	540	470	26	190	10	80	M12 x 180	28,1
2215 / L	400	408	435	596	515/542	30	170	10	70	M12 x 160	28,3
2216 / L	400	425	448	596	515/542	30	190	10	80	M12 x 180	29,8
2216 / LE	400	438	458	596	515/542	30	190	10	80	M12 x 180	29,8
2217 / L	400	465	490	630	525/570	30	300	83	155	M12 x 290	44,3
2217 / LE	400	480	500	630	525/570	30	300	83	155	M12 x 290	44,3

COMPONENTS			
	Name	Material	Coating
1	Centre sleeve	GGG-50	EPOXY RAL-5015
2	End ring	GGG-50	EPOXY RAL-5015
3	Bolts	Quality 6.8	GEOMET
4	Rubber seal	EPDM	
5	Flat gasket	EPDM	

Ref. 2211/L and above are supplied with flat joint.
Ref. 2214-A please specify PN10 or PN16

MATERIAL: GGG-50
USE: Cast iron, steel, PVC-U / -B0, asbestos cement.

- Bigger sizes upon request.